

**STIEBEL ELTRON**

High Quality  
**WATER FILTER**  
by Stiebel Eltron / Germany

USER MANUAL | FLOW WATER FILTER PITCHER



**Flow**

The water filter pitcher can only be used with pre-filtered water (tap water) from a water supply facility.  
The system and installation need to comply to state and local laws and regulations.

---

## SHORT OVERVIEW

### FLOW FEATURES

---

STEP

01

#### **Micro Net**

Removes suspended particles.

STEP

02

#### **Ion Exchange Resin**

Removes heavy metals: lead, cadmium, copper, mercury and aluminum.

Removes limescales.

Remains calcium magnesium and natural mineral substances.

STEP

03

#### **Silver Activated Carbon**

Removes chlorine up to 98% by high quality carbon.

Removes taste and odor.

Removes endrin, pesticide and residual pollutants.

High performance silver ion in the carbon to prohibit the growth of bacteria inside the cartridge.

Improves the taste of water.

STEP

04

#### **Micro net**

Net at cartridge's base provides additional particles filtration.

STEP

05

#### **Ultrafiltration membrane**

Hollow fiber membrane removes bacteria and particles down to 0.01 micron.

#### **The 7 benefits of using Flow water filter pitcher**

- Ideal for cold and hot drink
- Improve the taste of tea
- Better flavour and aroma from coffee
- Exceptional result from cooking
- Crystal clear ice
- Bacteria free direct drinking water

---

# USER MANUAL FLOW

## CONTENT

---

1. Components and product specifications	4
2. Precautions	5
3. Operating Instruction	6
4. First use and replacement of the lifetime counter	6
5. Filter replacement	7
6. Trouble shooting	7

# USER MANUAL FLOW

## COMPONENTS AND PRODUCT SPECIFICATIONS

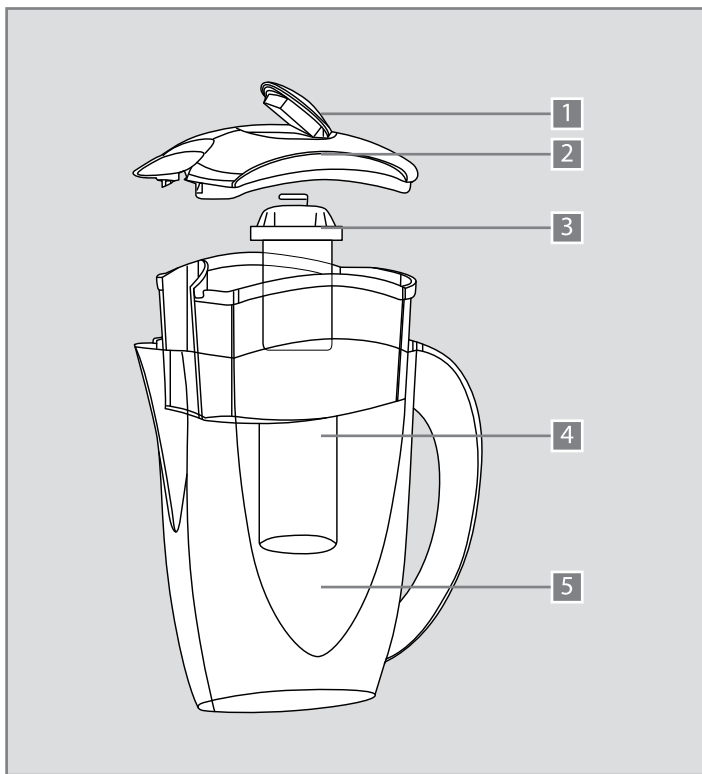

### COMPONENTS

- 1 Lifetime counter
- 2 Pitcher cover
- 3 Filter cartridge
- 4 Filter holder
- 5 Pitcher body

### PRODUCT SPECIFICATIONS

Product name	Flow water filter pitcher with membrane
Product code	1511-222298
Product Size (H x W x D) (mm.)	280 x 260 x 10
Filter water volume	1.0 L
Max. operating temperature	35 °C
Min. operating temperature	4 °C
Gross weight (without water) (kg.)	0.68
Filter type	5 stages in 1 encapsulated filter
Step 1	PP
Step 2, 3	Ion exchange resin/silver activated carbon
Step 4	Micro net
Step 5	Ultrafiltration membrane
Pitcher body	Safe and high quality AS plastic
Colour	White
Lifetime of cartridge	70 days (based on 12L/day) (depends on water quality)
Lifetime of Indicator	18-24 months
Flow cartridge code	1711-222316

# USER MANUAL FLOW

## PRECAUTIONS



The water filter pitcher can only be used with pre-filtered water (tap water) from a municipal water supply facility.

The filter pitcher can not be used with water from unsafe water sources such as rivers and wells.



If persons with weak immune systems, such as babies or the elderly, have been advised to drink boiled tap water then the water placed into this product for consumption by these persons must also be boiled, prior to or after filtration

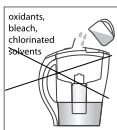

Do not apply concentrated cleaning agents such as heavy oxidants, bleach, chlorinated solvents, or the like to any part of this product. Do not use abraive pads on the product, this product is not fit for the dishwasher



Discard the first two full pitchers of filtered water before use.

Do not soak the cover under water or do not let water splash on the lifetime counter to avoid damage of the counter

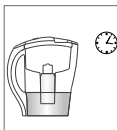

In order to ensure fresh filter water quality, please consume the filtered water right after filtered

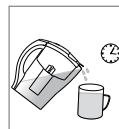

If you will not use the water filter pitcher for more than 2 days, please pour out the water inside the pitcher and keep the pitcher clean and dry. Should you not have your pitcher in use for a prolonged period (e.g. vacation), Please wrap the cartridge in a clean plastic bag and store it in the fridge

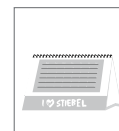

Upon your return from holiday, soak the cartridge for 20 minutes before use

Replace the filter according to the schedule to insure clean drinking water quality.

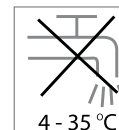

The water filter pitcher can only be used with the cold water supply with a water temperature from 4 to 35 degree C.

The water filter pitcher must be placed in a far distance to inflammable materials and heating sources to avoid deformation.



The water filter pitcher should not be exposed to force or shock.



The water filter pitcher must be kept away or protected from direct light (e.g. sunlight).

# USER MANUAL FLOW

## OPERATING INSTRUCTION, FIRST USE AND RESET OF THE LIFETIME COUNTER

### A: FIRST USE AND OPERATING INSTRUCTION

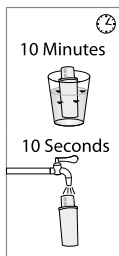

1. Open the filter cartridge packing just before use. Wash the filter cartridge thoroughly with tap water
2. Soak the filter cartridge upright into tap water for about 10 minutes then wash it under running water for 10 seconds



3. Wash the filter holder and pitcher body thoroughly before use

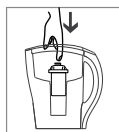

4. Insert the filter cartridge into the filter holder and gently press in

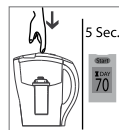

5. Please press "start" for more than 5 seconds on the counter. The counter will display 00 and blinking. Press "start" again, the counter will display the usable life of cartridge as 70 days and the set/reset is then completed. In any case, change the filter cartridge when the lifetime is reached



6. Pour tap water into the pitcher via filling tunnel. Please note that do not over fill the pitcher other wise water will overflow. Do not let water splash on the lifetime counter to avoid damage of the counter

Wait for the filter process to be done. Discard the first two full pitchers of filter water before use

### B: RESET OF THE LIFETIME COUNTER

- When 00 is displayed on the counter, this is the time you need to replace the filter cartridge.
- After changing the filter cartridge, please reset the counter by following the step in item 5 above.

# USER MANUAL FLOW

## PRODUCT SPECIFICATIONS AND TROUBLE SHOOTING

### FILTER REPLACEMENT

1. Wash your hand thoroughly with soap and water, open and remove cartridge from its bag
2. Open the pitcher cover and take out the existing cartridge.
3. Wash the new filter cartridge thoroughly with tap water
4. Soak the cartridge into tap water for 10 minutes and wash it under running water for 10 seconds
5. Wash the filter holder and pitcher body thoroughly
6. Insert the new filter cartridge into the filter holder and gently press in
7. Reset the lifetime counter following steps in Page 6 item 5
8. Discard the first two full pitchers of filtered water before use

### TROUBLE SHOOTING

Problems	Possible cause	Trouble shooting
Black color or black particles in the water.	The pitcher contains carbon powder. After pour water in, small particles can occur in the water.	Following the filter replacement steps in Page 6, step 6.
The counter shows 00	Lifetime of cartridge is finished Forget to reset the counter after changing cartridge	Change filter cartridge then reset the counter by pressing "start" for 5 second until number 70 appears. Reset the counter following Page 6 item 5.
Unusual water or chlorine taste/ bad odor.	The lifetime of cartridge is finished (this can be before lifetime in case tap water is not as clean as tap water standard).	Replace the filter cartridge.
	You do not use the pitcher for a while and some sediments and contaminants developed a bad smell in the system.	You must follow the conditions of keeping the cartridge properly in the Page 5 (Precautions).
The counter do not show any thing.	Lifetime of the counter is finished.	Contact your local dealers or Stiebel Eltron service center to change the expired parts
	The counter might be damaged.	Contact Stiebel Eltron for service.

GERMANY

STIEBEL ELTRON INTERNATIONAL GMBH | DR.-STIEBEL-STRASSE | 37603 HOLZMINDEN

PHONE: +49 0180 370 2003 | E-MAIL: INFO@STIEBEL-ELTRON.COM | WWW.STIEBEL-ELTRON.COM

**STIEBEL ELTRON**