

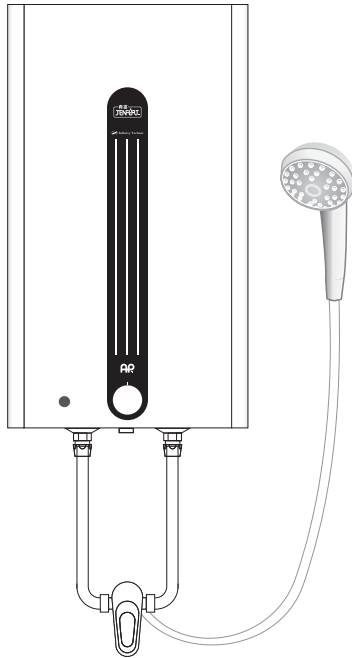

花灑 儲水式電熱水器

Single-Point Shower Unit Electric Storage Water Heater



JN 系列
Series

安裝及操作使用說明書
Installation and Operation Manual

致各位客戶，
Dear Customers,

多謝選購真富JN花灑儲水式電熱水器系列。

Thank you for choosing Jenfort JN Series Single-Point Shower Unit Electric Storage Water Heater.

請閣下於安裝及使用電熱水器前，細閱本安裝及操作使用說明書，並保留此說明書作日後參考。

All customers MUST read this Installation and Operation Manual before installing and using your electric water heater. It is advised to keep this manual for future reference.

本電熱水器必須經由合資格的工程人員安裝及測試，才可使用。

All installation or inspection MUST be carried out by a qualified technician.

本電熱水器必須正確連接地線，才可使用。

This electric water heater MUST be properly earthed before use.

兒童、長者及殘疾人士必須由成人或監護人的陪同下才可使用本電熱水器，以免發生燙傷或其他意外。

Children, elderlies and people with disabilities are only allowed to use this electric water heater if they are under the supervisions of an adult or a person responsible for their safety to prevent from scalding or other injuries.

如果閣下對本說明書有任何問題，請聯絡代理商或合資格的專業人士提取意見

If you have questions regarding this manual, please consult the agent or an authorized party for their professional advice.

榮獲 ISO9001: 2015 生產管理認證
Awarded ISO9001:2015 The Management System



榮獲香港工業總會優質標認局頒發
Awarded Hong Kong Q-Mark Product Scheme



香港Q標優質產品計劃
www.qmark.hk

維修服務熱線 : 3563 6960
Service Hot-line

總代理 Sole Agent



A-PLUS (HK) GROUP LTD.
愛家(香港)集團有限公司

目錄

Contents

1. 產品及配件	
Product and Accessories	3
2. 產品特點	
Product Features	4
3. 產品安裝指引	
Instructions for Installation	5-6
4. 安裝注意事項	
Precautions for Installation	7
5. 產品操作指引	
Product Operating Instructions	8
6. 操作注意事項	
Precautions for Operations	8-9
7. 技術參數	
Specification	9
8. 常見問題	
Trouble Shooting	9
9. 保養條款	
Warranty Terms and Conditions	10

★ 如本說明書有任何更改，恕不作另行通知 ★
This information in this manual is subject to change without prior notice ★

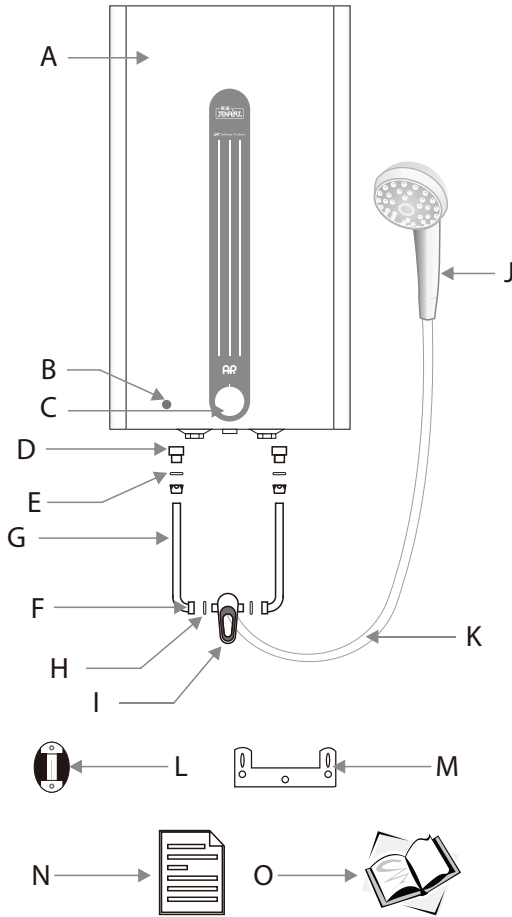

- A: 主機
Main Body
- B: 指示燈
Indication Light
- C: 恆溫掣旋鈕
Thermostat Control Switch
- D: 喉管接駁器(2)
Pipe Nut
- E: 膠圈(2)
Plastic Ring
- F: 固定螺母(2)
Fixing Nut
- G: 接駁喉管(2)
Connection Pipe
- H: 防漏膠墊及膠圈(2)
Plastic & O-ring
- I: 開放式混合龍頭
Non Pressure type water Mixer
- J: 花灑頭
Energy Saving Shower Head
- K: 花灑頭接駁軟管
Shower Hose
- L: 花灑頭固定座
Shower Head Stand
- M: 牆壁掛架
Wall Mounting Bracket
- N: 保養卡
Warranty Card
- O: 安裝及操作使用說書
Installation and Operation Manual

請注意：配件D至O是分開包裝於配件盒之中。

Please note: Accessories D - O are packed separately in the accessories package.

B:	指示燈 Indication Light	<ul style="list-style-type: none"> - 紅色:正在加熱 - Red light indicates water is in the heating process
C:	恆溫掣旋鈕 Thermostat Control Knob	<ul style="list-style-type: none"> - 向右旋轉可增加水溫 - 向左旋轉可減低水溫 - Turn clockwise to increase water temperature - Turn anticlockwise to decrease water temperature

每一部電熱水器均包括以上之標準配件；如因使用未經許可的配件而導致任何損壞，客戶需自行負責因該損壞造成的損失及責任。

Each unit is provided with a standard accessories package as stated above; if any damage on the heater occurs which is caused by using any unauthorized accessories incorrect installation or physical damaged, the warranty will not apply on these circumstances and customers shall be responsible for any cost to rectify the situation.

出水溫度穩定

Stable water temperature.

在水壓不穩的情況下，仍可出水流暢

Suitable for unstable water pressure.

防超溫安全保護裝置

Equipped with an overheat safety cutout.

優質保溫層，保溫力特強並減少熱量流失

High density insulation layer reducing heat loss to the minimal, temperature can be preserved longer enhancing energy saving.

五分鐘快速加熱，即可達到舒適水溫，以供漱洗用途

Provide comfortable temperature for the morning freshen up in just 5 minutes.

符合國際電工協會IEC-60335-1，IEC-60335-2-21安全標準

Compliant to the IEC-60335-1, IEC-60335-2-21 Standard

真富JN花灑儲水式電熱水器系列之熱水器在水壓不穩的情況下，仍能提供穩定而流暢的熱水。為達至安全目的，JN系列內置防超溫安全保護裝置。

Jenfort JN Series Single-Point Shower Unit Electric Water Heater can provide constant hot water under unstable water pressure situation. For safety purposes, JN Series also equipped with an overheating protection system;

當水溫超出一定的水溫限制時，防超溫安全保護裝置會自動切斷電源。另設有優質保溫層，減少熱量流失，節省能源。

When the water temperature exceeds the preset limit, the system will cut the power off automatically. In addition, for energy saving, the high density insulation layer can reduce heat loss to the minium.



警告

本熱水器的出水位只作為排水及排氣之用，客戶必須使用由生產商提供的原裝花灑配件。請勿接駁任何其他水掣設備以免出水位被阻塞。如因此而導致任何損壞，客戶需自行負責因該損壞而造成的損失及責任。

The water heater outlet is designed to drain out water and air, customer must use the original shower set provided by the manufacturer. Do not connect with any other water device or system which will block the water outlet. If so, customer shall be fully responsible for their any loss and which is caused by these circumstances.

3.1 牆壁掛架安裝指引

Installing the Bracket

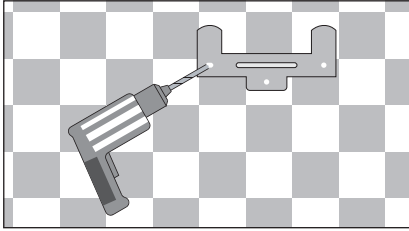

3.1.1

請選擇一幅能承受熱水器重量的牆壁或混凝土牆，記下正確的位置，並用合適螺絲固定裝上牆壁掛架。

Choose a concrete wall that is strong enough to bear the weight of the heater. Mark the position for fixing the mounting bracket and secure it with suitable Screw.

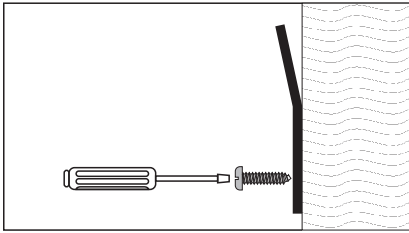

3.1.2

請確保所有接合點連接正確，並無滲漏。

Make sure all the parts are well connected without any leakage.

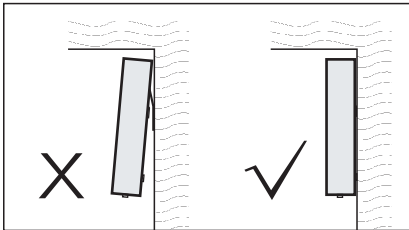

3.1.3

請根據圖示把熱水器垂直安裝；傾斜度不能大於5度。

Install the water heater vertically as shown; the gradient CANNOT be greater than 5 degrees.

警告

於完成安裝熱水器後，必須關閉電源，開啟水龍頭並轉至紅點位置，讓冷水及氣泡流出至少一分鐘，然後可關閉水龍頭。

此步驟只需在第一次安裝後、每一次維修後或暫停供水後進行，以避免因水箱沒水或合適的水量而導致發熱管損壞。

After the installation of the water heater, **make sure the power supply is switched off** and turn on the Non Pressure Type Water Mixer. Keep the hot water on until the tank is completely full and water running out for at least 1 minute before turning off.

This procedure is only required after the first installation, maintenance or water shortage, to prevent the damage of the heating element when the inner tank is empty or without suitable water level.

3.2 水電安裝指引

Plumbing and electrical installation instructions

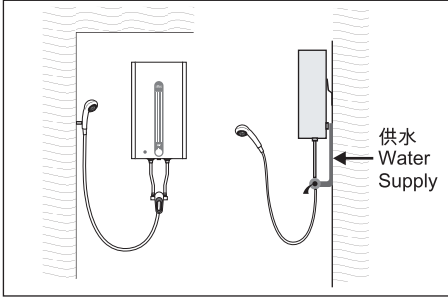

3.2.1 請確保單控式混合水龍頭安裝於穩固的牆壁上，並接駁至自來水管及接駁喉管。
Secure the mixer tap on the stable wall and attach it to water supply pipe and the connection pipe.

3.2.2 請把接駁喉管接駁至熱水器。
Attach the connection pipe to the water heater;

3.2.3 請把花灑頭固定座安裝於適當的位置，再連接接駁軟管至單控式混合水龍頭。
Fix the shower head holder to a suitable position and then connect the shower head with the shower hose and the mixer tap;

Fix the shower head holder to a suitable position and then connect the shower head with the shower hose and the mixer tap;

3.2.4 請安裝電源開關掣於浴室外之適當位置，然後用標準電線把電源開關及熱水器的電源接線座上相應的接線端連接好。
Power switch should be installed on an appropriate position outside the bathroom, connect the power switch with the corresponding wire terminal of the power terminal block of the water heater with standard wiring;

Power switch should be installed on an appropriate position outside the bathroom, connect the power switch with the corresponding wire terminal of the power terminal block of the water heater with standard wiring;

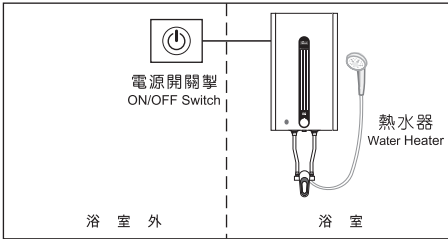

3.2.5 所有電線安裝必須根據發熱線的功率及當地的電力條例。載流量必須符合熱水器的額定功率，並預留有額外安全容量。
Depending on the power rating, installation must comply with the local electric power regulation. The current-carrying capacity must fulfill the water heater's power rating and have reserve for extra capacity.

Depending on the power rating, installation must comply with the local electric power regulation. The current-carrying capacity must fulfill the water heater's power rating and have reserve for extra capacity.

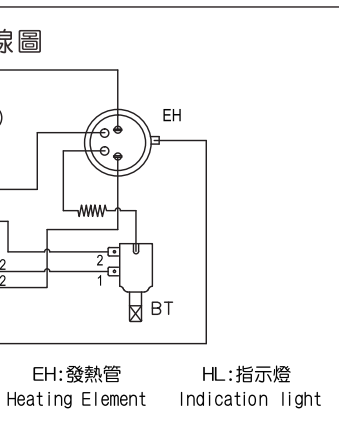
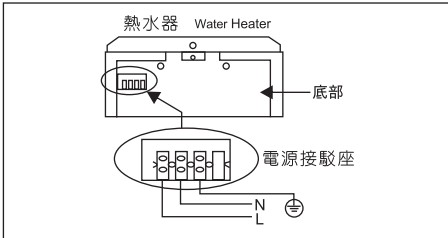

4.1 安裝熱水器之基本條件

Basic requirements for installing the electric water heater

- 4.1.1 必須使用經批准及安全的供電系統。
Electricity supply must be provided by authorized parties.
- 4.1.2 必須使用經批准及穩定的供水系統。
The water supply system must use approved and stable.
- 4.1.3 必須安裝於固定的混凝土實心磚牆或足以承受熱水器重量的牆壁上。
Must be installed on concrete wall which is strong enough to bear the weight of the heater.

4.2 安裝熱水器之安全守則

Safety rules for electric water heater installation

- 4.2.1 此熱水器電源須獨立接駁於配電箱，並須根據當地電力標準及條例。
Electrical wiring of the heater must be directly connected to the individual main supply, complying to the standard and regulations of the local electricity regulation;
 - 4.2.2 根據使用電力條例及地方標準，熱水器必須連接至以下其中一種安全斷路系統：
According to the electricity regulations and local standard, the water heater MUST be connected to one of the open circuit systems as shown below:
 - 合適的自動斷路系統
A suitable MCB System
 - 合適的漏電斷路系統
A suitable RCCB System
 - 4.2.3 所有安裝必須由合資格的技術人員進行及完成，並使用原裝配件。代理商、生產商或供應商，不會承擔因不正確或非授權之安裝引致的故障及損壞的責任。
All installation MUST be carried out by a qualified technician and to use all the original accessories. The Sole Agent, manufacturer or suppliers will not be responsible for any defect or damage caused by incorrect installation.
 - 4.2.4 安裝的位置必須有足夠的地面排水位。
The position for the installation must provide adequate floor drainage.
- 4.3 電源開關掣必須達至國際電工協會IEC最新標準，並必須安裝於浴室之外。
The power supply switch must comply with latest IEC standard and it must be located outside the bathroom.
 - 4.4 熱水器的安裝必須穩固，並正確地接駁電源。
The installation of the water heater must be stable and properly connected with the power supply.
 - 4.5 為避免損壞熱水器，使用時最高水壓不能超過0.4MPa及入水流量不可超過每分鐘8公升。
To avoid any damage to the appliance, the maximum water pressure cannot exceed 0.4MPa and the inlet water flow rate should not exceed 8 liters per minute.
 - 4.6 本熱水器不能接駁任何外置的自動開關裝置。
例如，定時器或連接到由通用部件定時進行通斷的電路。
The appliance cannot be installed together with any external power control.
e.g. Timer or other Power Supply controlled by a specify device.
 - 4.7 在沒有監督的情況之下，兒童、殘疾或傷殘人士，都不應獨自操作本熱水器，以免燙傷、觸電或其他意外。
Do not allow children, people with physical or mental disabilities to operate the water heater without any supervision, to prevent from scalding, electric shock or any other injuries.
 - 4.8 若本產品之安全斷路器被啟動後，將不能自動重設。建議客戶由合資格技術人員進行重設斷路器及請必先關閉電源方可進行。
If the safety thermal cut out is activated, it can be re-set automatically. Customer is advised to inform the qualified parties and have them reset the cut out without any power supply to the unit.
 - 4.9 安裝掛牆式電熱水器時，建議安裝於離地面至少150厘米的位置。
When installing a wall-mounted unit, a minimum clearance of 150cm is recommended from the floor to the unit.

5.1 操作指南 Operating Guide

- 5.1.1 熱水器必須安裝於一個正確的位置，並依照安裝指引進行方可使用。
Water Heater must be installed in a proper location and to follow the installation instructions before use.
- 5.1.2 開啟熱水器之前，請確保水箱內含水；當開啟電源掣後，紅色顯示燈亮起，熱水器會立即開始加熱。
Make sure the inner tank is filled with water and the power supply is on, the unit will immediately start heating up and the heating indication Red light will come on.
- 5.1.3 當水溫達到預設的溫度時，加熱指示燈會自動熄滅。
When the water temperature reaches the per-set temperature, the heating indication light should go out.
- 5.1.4 當使用熱水器時，首先開啟單控混合水掣冷水至正常流出冷水，再逐漸開啟單控式混合水掣熱水，調至適合的沐浴之水溫。沐浴後先關閉混合水掣熱水，再關閉冷水。
When drawing hot water, firstly turn the cold water on to a suitable flow and slowly mix in the hot water until a suitable temperature is reached. Remember to turn the hot water off first when hot water is no longer.

6. 操作注意事項

Precautions for Operations

- 6.1 在加熱過程中，如花灑頭有滴水的情況出現，這是正常排氣現象。為確保安全，請勿擅自更換或改裝任何原裝零件及配件。
During the heating up process, it is absolutely normal that water drips out from shower head as it is a sign of releasing the excess pressure from the tank. Do not attempt to replace or change any of the original parts and accessories.
- 6.2 請勿在熱水器上放置任何物件。
Do not put any objects on top of the water heater.
- 6.3 本熱水器之最大入水壓力為0.4 MPa。
The maximum inlet water pressure for this water heater is in pascals : 0.4 MPa.
- 6.4 熱水器的供電電源需定期由合資格的技術人員進行檢查。如發現電線有任何損壞或過熱的情況發生，必須立即關閉電源，通知代理商或代理商授權的技術人員安排檢查。
Regular check up of the power supply to the water heater is essential and should be performed by a qualified technician. Any damage found or the cable has a sign of overheat, switch off the power supply immediately. Inform the agent to arrange a check up.
- 6.5 請勿與其他家電設備供同一電源或不應使用電源延伸座接駁電源及熱水器。
Do not share the same power supply with other electric appliance and do not use extension cable to connect the power supply to the water heater.
- 6.6 如熱水器發生故障，切勿自行維修或更換零件；請聯絡代理商或其認可的服務中心安排檢查或維修。
If there is a fault of the water heater, do not attempt to repair or replace any component parts by yourself; contact the agent or an authorized party to arrange an inspection.
- 6.7 如長時間不會使用熱水器，請關閉電源；在重新使用前，先進行檢查，並把熱水龍頭打開直至水注滿內膽，及確保水箱有足夠水量方可開啟電源。
If the water heater is not going to be used for a long period of time, please switch off the power supply before re-use, perform the checking procedure by drawing hot water to ensure the water tank is full before switching on the power.
- 6.8 請使用原裝配件。請勿使用任何未經許可附有按摩功能的花灑頭至真富JN花灑儲水式系列之電熱水器上。
Please ensure the use the original accessories and DO NOT replace the shower head with massage function or other kinds that will alter the water flow to the JN Shower series .

- 6.9 在停水期間，請勿開啟或使用本熱水器。
During water shortage, do not use or switch the water heater on.
- 6.10 安裝本熱水器之地台位置，必須有適當的地台排水設施。
The location for the installation of the water heater should have an adequate floor drainage.
- 6.11 如需把水箱內的水排空作清潔或維修工作，請先關閉電源，再鬆開連接水箱及混合水掣之間的兩條連接喉管，水箱內的水便會從右邊的水管排出直至排空。
Prior to any maintenance or repair, it is required to drain out all the water from the tank before carrying out any work. Switch off the power, disconnect the 2 pipes from the tank and the water mixer. Water will then drain out from the water pipe located on the right hand side.

7. 技術參數

Specifications

花灑儲水式電熱水器系列				Single-Point	Shower	Unit	
型號	Model			JN-4	JN-5	JN-6	
容量(公升)	Capacity(Liters)			15	18	23	
呎吋(毫米)	Size(mm)	高	W	深D	500 330 256	563 330 256	688 330 256
水喉	Inlet Size			ø 1/2"			
功率(千瓦)	Power Rating(kW)			3kW			
電壓	Voltage / Phase			220V / 1 Phase			
恆溫控制	Thermal Control			由35°C到85°C可自由調較 35°C-85°C Adjustable			
超溫斷路器	Thermal Cut-Out			90°C可重置式	90°C Manual - Resettable		
測試/工作水壓	Test/Max. Working Pressure			0.4 MPa / 0 MPa			
防護等級	IP-Rating			IP21			

8. 常見問題

Trouble Shooting

指示燈狀態 Indication Light Status	狀況 Condition	一般原因 Reason in general
沒有顏色 No Color	指示燈沒有亮起，沒有熱水供應 Indication light does not come on and no hot water supply	未有連接電源 Power supply failure
沒有顏色 No Color	指示燈長時間沒有亮起，但有熱水供應 Indication light does not come on for a long time but hot water is available	指示燈損壞 Indication light is faulty
紅色 Red color	紅色加熱指示燈長時間亮起，但沒有熱水供應 Indication light is on for a long time but no hot water supply	發熱管損壞 Heating element is damage
紅色 Red color	紅色加熱指示燈長時間亮起，但出水溫度過熱 Indication light is on for a long time but water is too hot	恆溫掣故障或損壞 Thermostat failure or damage

- 9.1 電熱水器在自然損耗情況下，水箱保用十年，其他配件保用兩年。
Under the natural wear and tear circumstances, the water tank will have a 10 year guarantee; where other parts will have a 2 year guarantee.
- 9.2 上述之保養服務將會由購買日起開始生效，如產品在保養期內發生問題，代理商將會提供維修或更換零件的服務。
The above warranty will start on the date of purchase. If any problem occurs within the warranty, the agent will be responsible for the maintenance or parts replacement that states within the warranty agreement.
- 9.3 如損壞由以下情況所引起，此保養將不會生效：
The warranty will become invalid if the damage is caused by the followings:
- 9.3.1 未有按照本說明書安裝或使用本熱水器；
Installation or usage that does not comply with the instruction manual;
- 9.3.2 使用非生產商提供之配件；
Usage of any accessories which are not provided by the manufacturer;
- 9.3.3 由未經許可之人員進行安裝或改裝本熱水器。
The water heater was installed or refitted by an unqualified person.
- 9.4 如熱水器用於商業用途，本保養將自動失效。
This warranty will no longer be applicable if the water heater is used for commercial purposes.
- 9.5 如損壞是由自然災害、人為錯誤或疏忽、濫用或誤用所引致，本保養將自動失效。
This warranty will not cover damages that caused by natural disasters, human errors, misused or any other inappropriate manners.
- 9.6 任何公共交通工具不能到達之偏遠地區或非辦公時間內提供服務，本公司將會收取附加費。
A supplementary charge will apply where the service location is classified as remote areas and not be accessed by public transports; and or when service is required during non office hours.
- 9.7 兩年保用期屆滿後，本公司會另外再提供八年內膽保用。此服務只應用於熱水器內膽之維修；其他費用，如檢查、運送、人工或裝拆均需額外收費。
When the 2 years warranty period is up, A-Plus will provide an additional 8 years warranty on the inner tank. This additional warranty applies only to the maintenance of the inner tank extra cost such as inspection, transportation, labor or installation may apply on this additional warranty.
- 詳情請向本公司客戶服務部查詢。
For more enquirers please contact our Customer Service hot-line.
- 9.8 此服務只適合於香港使用
This service is only valid in Hong Kong.

總代理 Sole Agent

 **A-PLUS (HK) GROUP LTD.**
愛家(香港)集團有限公司

香港葵涌青山公路403號匯城集團大廈5樓A-E室

Unit A-E, 5/F, Reason Group Tower, 403 Castle Peak Road, Kwai Chung, N.T., Hong Kong

電話號碼 Tel. : 3563 7238 傳真號碼 Fax. : 3563 8793

電郵 E-mail : company@aplusgroup.hk

網址 Website : www.aplusgroup.hk

APJHwTA1809MAN
180926_095MKT